



ELEMENT
HOME BUILDERS

FEATURED DESIGN SELECTIONS

Blossom on Lot 6



Design
SPECIFICATIONS - INC.

Each Element home is a unique work of art in progress. As construction evolves, subtle changes from the specifications shown here may naturally occur. While we strive to represent materials, colors, and textures as accurately as possible, many of the elements we use are natural products—meaning slight variations in color and texture are to be expected and are part of their inherent beauty.



Blossom on Lot 6

4,388 Sq. Ft. · 5 Beds · 5 Baths · Powder Bath · 2-Car Garage

Features: Office · Golf Cart Storage · Pool & Spa · Lanai · Summer Kitchen

Welcome to Blossom on Lot 6, a beautifully designed new construction home nestled in the heart of Oakland's premier community—Grove at The Harvest District. With over 5,000 square feet of livable space, this thoughtfully crafted residence offers a luxurious blend of comfort, functionality, and indoor-outdoor living.

Featuring 5 bedrooms, 5 full bathrooms, and a powder bath, this home provides ample space for entertaining and everyday living. The open-concept layout includes a spacious loft, a 2-car garage with additional golf cart storage, and seamless flow between the interior and exterior living areas.

Step outside to your private pool and spa, covered lanai, and fully equipped summer kitchen—perfect for enjoying Florida's year-round sunshine in style.

Blossom on Lot 6 offers a rare opportunity to own a brand-new thoughtfully designed retreat just minutes from Winter Garden and the charm of historic Oakland.

LOT 6

BLOSSOM FLOORPLAN

STANDARD FIRST FLOOR

STANDARD SECOND FLOOR



Home plans and design renderings are subject to modifications.

GROVE

SITE PLAN



ELEMENT
HOME BUILDERS

GROVE AT HARVEST DISTRICT LOT 6 • FRONT EXTERIOR



MAIN ROOF
Shingle
Charcoal Gray



FRONT PORCH ROOF
Metal
Charcoal Gray



WINDOWS
White



STUCCO, TRIM, SOFFIT
Sherwin Williams
SW 7636 Origami White



**ACCENTED PAINTED
SHAKE, GARAGE
DOORS, & SHUTTERS**
Sherwin Williams
SW 2849
Westchester Gray



**FRONT PORCH
BRICK FLOORING**
Knob Hill



DRIVEWAY PAVERS
Belgard Pavers
Holland Stone 4x8
Slate



**DRIVEWAY PAVER
PATTERN**
Basketweave



**WOOD ELEMENTS
(COLUMNS, FRONT &
REAR PORCH CEILINGS)**
Minwax Weathered
Oak #270

GROVE AT HARVEST DISTRICT LOT 6 • BACK PORCH CEILING



STAINED T&G



PORCH CEILINGS
Minwax Weathered
Oak #270

GROVE AT HARVEST DISTRICT LOT 6 • GARAGE



GARAGE DOOR STYLE
Coachman Series REC13
Window Seeded Glass
Spade Lift Handles

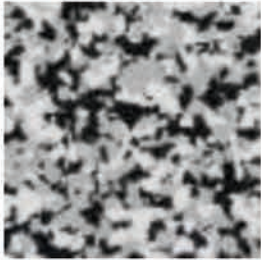

GARAGE FLOOR
Epoxy Domino



GARAGE DOORS
Sherwin Williams
SW 2849
Westchester Gary

GROVE AT HARVEST DISTRICT LOT 6 • EXTERIOR POOL



GROVE AT HARVEST DISTRICT LOT 6 · POOL

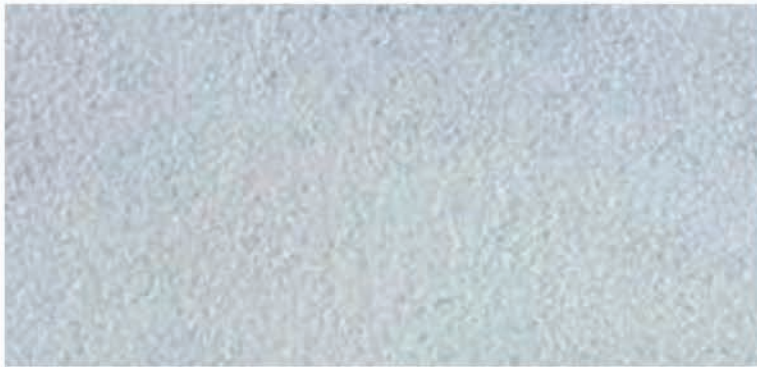

POOL PAVERS & COPING
Pyramid Arctic
White Sandblasted 12x24

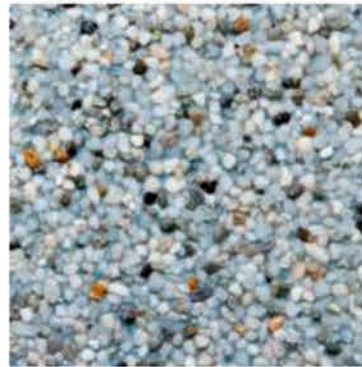

POOL INTERIOR
Stonescapes
Aqua Blue

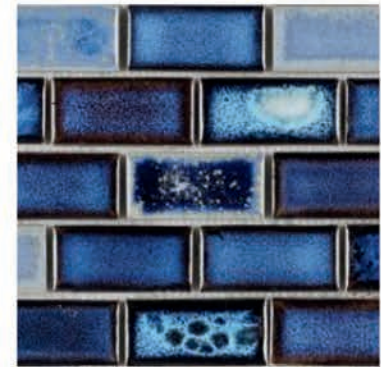

POOL TILE
Elysium Brick
Royal Blue Mosaic
Grout: Mapei Frost

GROVE AT HARVEST DISTRICT LOT 6 • SUMMER KITCHEN

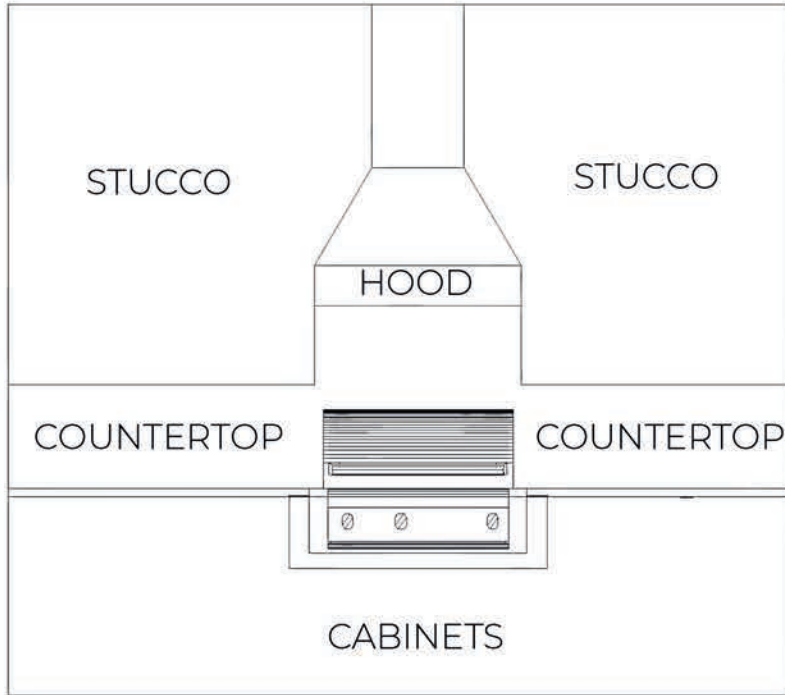

GRILL
Artisan Gas Grill AAEP-32 32"
Stainless



OUTDOOR BEVERAGE COOLER
PRB24C01AS-OD
24" Stainless



HOOD
Artisan Gas Grill
AK786CS
36" Stainless



COUNTERTOP & SHAPED
Backsplash: Compac
Terrazzo Pietra Titanium
Edge: Eased



PAVERS & COPING
Pyramid Arctic White
Sandblasted 12x24



CABINET HARDWARE
Richleau Modern Pull
2102128170
Stainless 5"

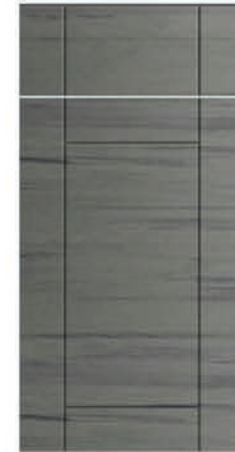

CABINET DOOR
STYLE
Sanibel
Dark Ash

GROVE AT HARVEST DISTRICT LOT 6 · FRONT DOOR & HARDWARE



FRONT DOOR
Full SDL
Horizontal 4 Light
Water Glass
Finish: Onyx Antique



Onyx Antique



FRONT DOOR HARDWARE
Craftsman ORB/Black

GROVE AT HARVEST DISTRICT LOT 6 · INTERIOR DOORS, HARDWARE & PAINT



INTERIOR DOORS
Molded Five Panel
Smooth Shaker
Painted Trim Color



**INTERIOR DOOR
HARDWARE**
Kwikset Tripoli
Matte Black

Walls
SW 7666 Fleur de Sel
Trim: SW 7005 Pure White
Ceilings: SW 7005 Pure White
(Level 4 Orange Peel on walls)



SW 7666
Fleur de Sel

SW 7005
Pure White

GROVE AT HARVEST DISTRICT LOT 6 • INTERIOR TRIM

8" Flat Stock Base Board, 4" Flat Stock door trim, Flat Stock windowsill, and Cove Crown throughout.
ADD Full Window Casement in Whole Home & Crown in Secondary Bedrooms and Hallways.

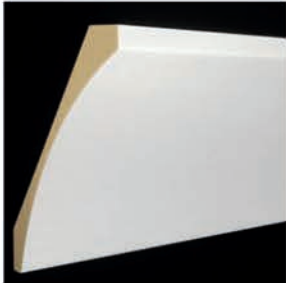

COVE CROWN



BASEBOARD
7 1/4" Flat Stock



DOOR CASING



3 1/4" Flat Stock Trim
Around Window

GROVE AT HARVEST DISTRICT LOT 6 • MAIN FLOORING



WOOD FLOORING

Anderson Tuftex:

15027 Pembridge

GROVE AT HARVEST DISTRICT LOT 6 • STAIR RAILING



HORIZONTAL ALUMINUM
Matte Black



Treads Stained to Match
Interior Wood Flooring
Anderson Tuftex: 15027 Pembridge

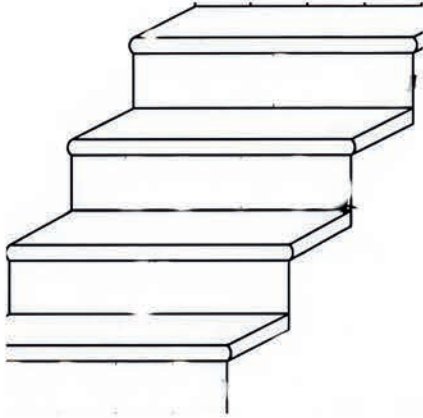

STAIR TREADS
Stained to Match Wood Flooring
Stair Risers: Painted White



INTERIOR STAIN
Minwax Classic Gray
#271

GROVE AT HARVEST DISTRICT LOT 6 • GATHERING ROOM FIREPLACE

PLEASE NOTE:

Fireplace has been widened to accommodate 50" fireplace and 85" T.V.

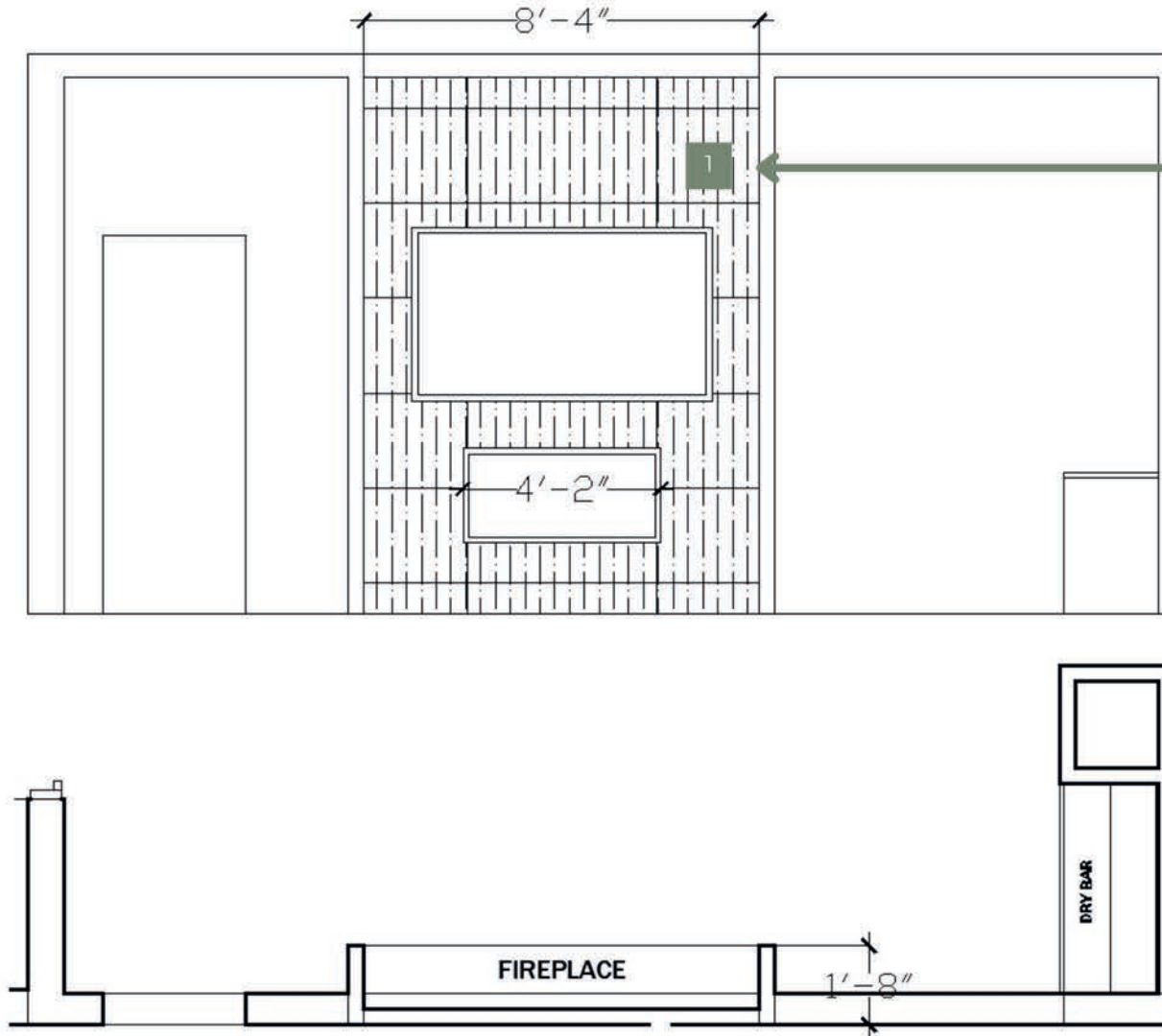

1



FIREPLACE
 Soho Elan Ribbon Black
 24x48 Install so Lines are Vertical, Wrap Sides,
 Black Schluter
 Grout: Laticrete Raven



50" Electric Linear Log Set Included



ADDITIONAL ADD-ON
 Black Glass Media

GROVE AT HARVEST DISTRICT LOT 6 • GATHERING ROOM BUILT-IN



CABINET DOOR STYLE
Prairie



CABINET HARDWARE
Island Richleau: #873 6" Brushed
Nickel



CABINET FINISH &
UPPER SHELVES
Wellborn Onyx



COUNTERTOPS
Quartz: Sonno Calacatta Biosa
Edge: Eased
Backsplash: Standard 4"

GROVE AT HARVEST DISTRICT LOT 6 • GATHERING, DINING, KITCHEN CEILING

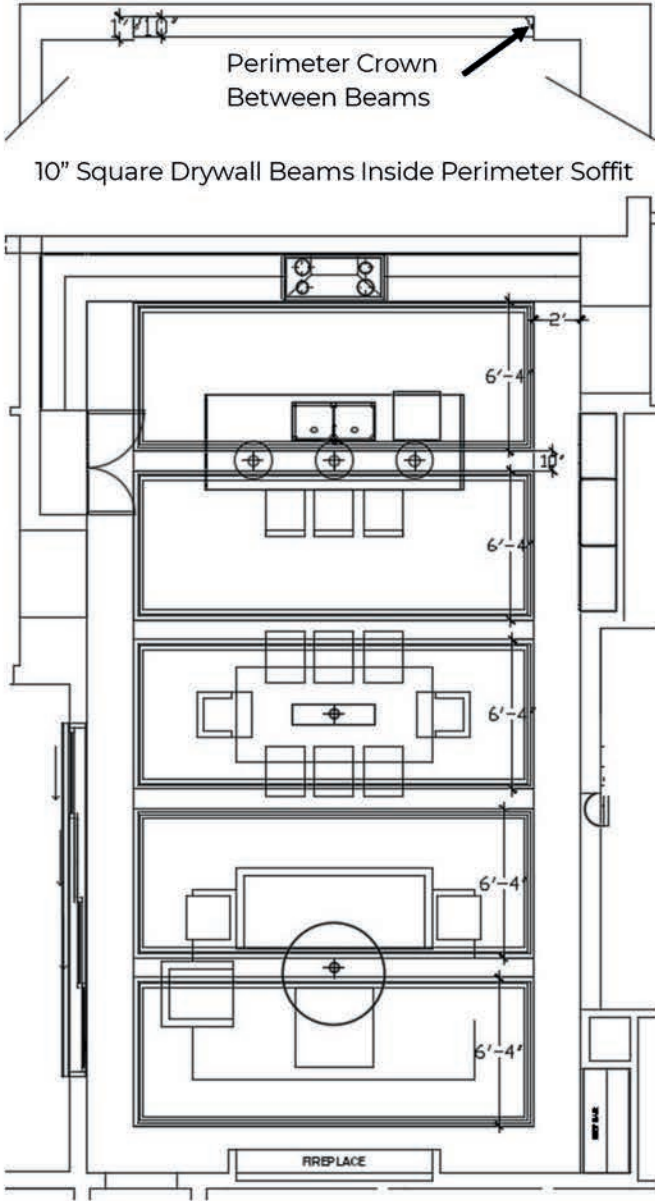

GROVE AT HARVEST DISTRICT LOT 6 • GATHERING FLOOR OUTLET LOCATIONS

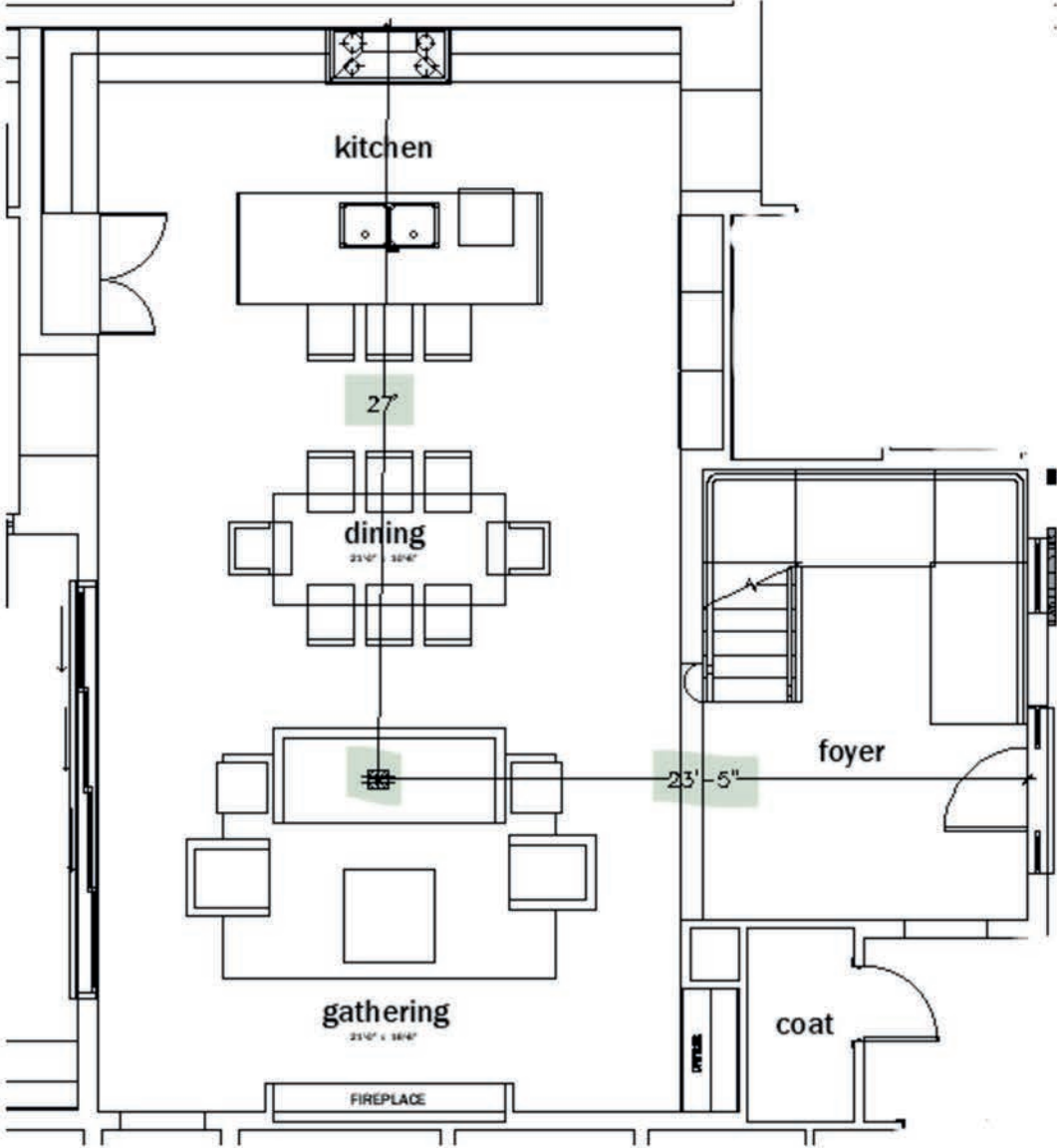

GROVE AT HARVEST DISTRICT LOT 6 • KITCHEN



**PERIMETER & ISLAND
DOOR STYLE**
Prairie



**ISLAND CABINET
HARDWARE**
Richleau: #873 6"
Brushed Nickel



**PERIMETER CABINET
HARDWARE**
Richleau: #873 6" Matte Black



HOOD STYLE
E200 Series DPI Base
Onyx Cabinet Finish w/ Stainless
Band



COUNTERTOP
Quartz: Sonno Calacatta Infinity
Full Height Backsplash & Waterfall Island
Edge: Eased



PERIMETER FINISH
Wellborn Whisper



ISLAND & HOOD
Wellborn Onyx

GROVE AT HARVEST DISTRICT LOT 6 • KITCHEN HOOD DESIGN & PLUMBING



HOOD STYLE
E200 Series DP1 Base
Onyx Cabinet Finish w/ Stainless Steel Band



HOOD FINISH
Wellborn Onyx



FAUCET
Kohler K22972 Crue
Single Hole Pull Down
Matte Black



SINK
Elkay EFRU3116100TC
Crosstown 32.5" Undermount SS
with Basin Rack & Basket Strainer

GROVE AT HARVEST DISTRICT LOT 6 • KITCHEN APPLIANCES



REFRIGERATOR
Thermador 36" French Door - 2 Drawer
Stainless w/ Ice Maker & Water
Dispenser



DISHWASHER
Thermador
DWHD640EFP Stainless



RANGE
Thermador
36" Gas Pro 6 Burner Stainless



MIRCROWAVE
Thermador
24" Microwave Drawer

GROVE AT HARVEST DISTRICT LOT 6 • KITCHEN PANTRY



FINISH
White Melamine

GROVE AT HARVEST DISTRICT LOT 6 • LAUNDRY ROOM



CABINET STYLE & FINISH
1951 Denver
Maple Linen



BACKSPLASH
MTD Astoria Bricks Mixed
Mesh Mosaic
Grout: Mapei Frost



FAUCET
Kohler K596
Simplice Stainless



COUNTERTOP
Quartz: Sonno Lagoon
Edge: Eased, w/4"
backsplash



CABINET HARDWARE
Richleau Brushed Nickel
Drawers: Pull BP8716128195
Doors: Knob BP872634195



FLOORING
Mohawk Sinova Cement Gray
12 x 24 Brick Joint
Grout: Mapei Silver



SIGNATURE HARDWARE
Medford 25"
Undermount Acrylic White

GROVE AT HARVEST DISTRICT LOT 6 • MUDROOM



CABINET STYLE & FINISH
1951 Denver
Maple Linen



Richleau 79629BAG
Classic Forged Iron Hook



STAINED SEAT
Minwax Classic
Gray #271



CABINET HARDWARE
Richleau BP9898128990
5" Brushed Black

GROVE AT HARVEST DISTRICT LOT 6 • HOME OFFICE



Built-in Shelving to The Ceiling Drop Soffit If Necessary



WOOD FLOORING
Anderson Tuftex:
15027 Pembridge



CABINET STYLE & FINISH
1951 Denver
Maple Harbor Countertop
Same Finish



CABINET HARDWARE
Richleau BP801160900
6" Matte Black

GROVE AT HARVEST DISTRICT LOT 6 • HOME OFFICE CEILING CONCEPT



INTERIOR STAIN
Minwax Classic Gray
#271

GROVE AT HARVEST DISTRICT LOT 6 .

HOME OFFICE CEILING

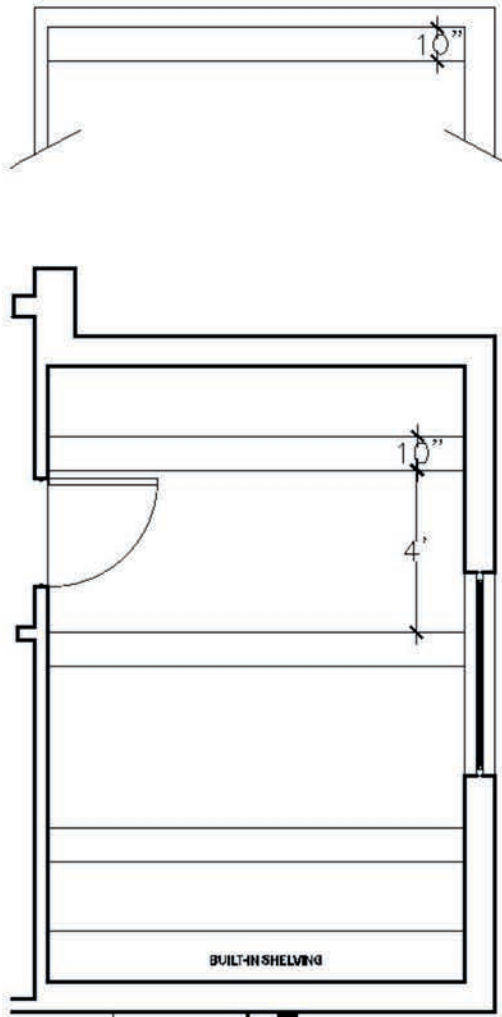

10" Stained Wood Beams Chandelier
Mounted to Center Wood Beam

HOME OFFICE FLOOR OUTLET

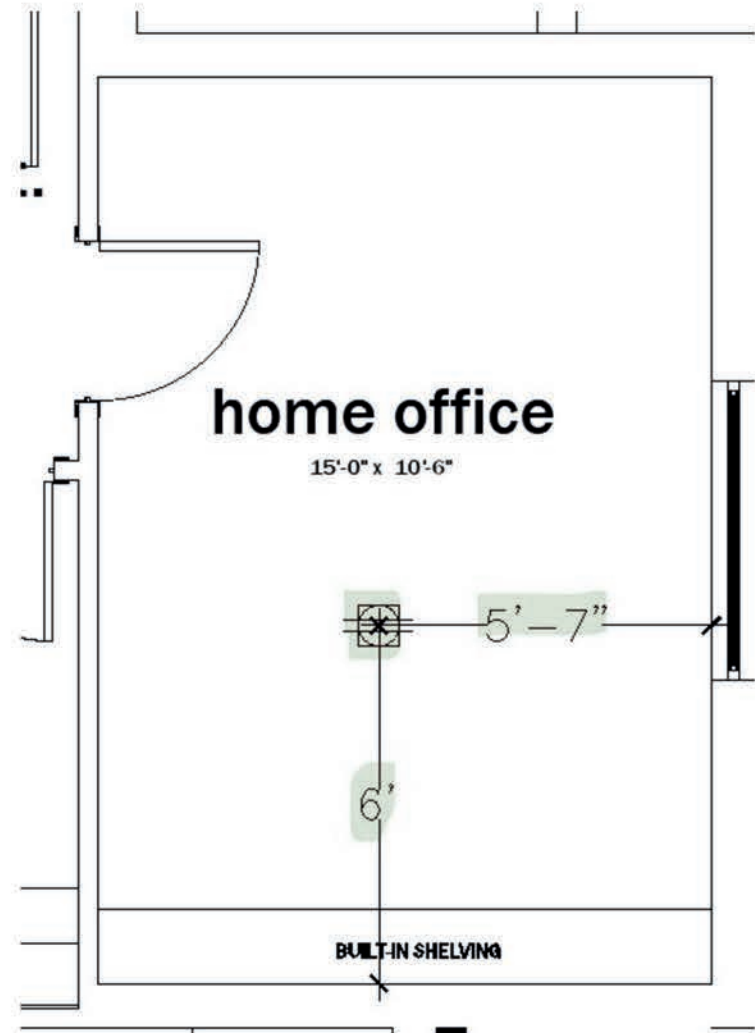

GROVE AT HARVEST DISTRICT LOT 6 • POWDER BATH

Mirror: Framed to Match Cabinets
 Bath Accessories: Brushed Nickel

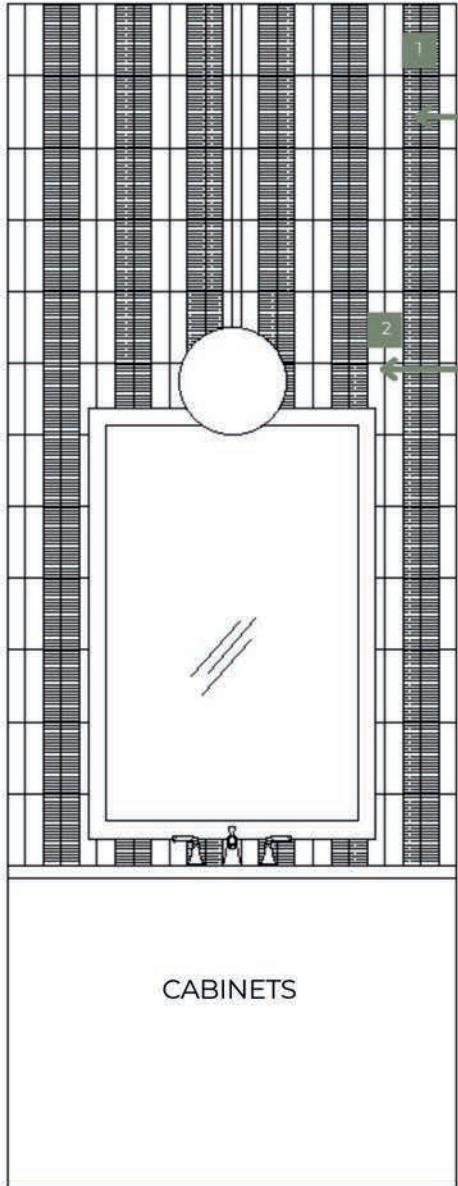

VANITY WALL
 Elios Ceramica Dust Line Ice Soft &
 Dust Ice Soft 2x8 Run Vertically,
 Two Rows Each Alternating
 Grout: Mapei White



COUNTERTOP
 Quartz: Wood Ash Polished
 Edge: Eased



FLOORING
 Tarmac: Sanibel Carrara/Dolomite
 Grout: Mapei White



CABINET HARDWARE
 Richleau: Matte
 Black/Brushed Nickel 801 6"



**CABINET FINISH &
 DOOR STYLE:**
 1951 Denver Maple Stone

GROVE AT HARVEST DISTRICT LOT 6 • POWDER BATH PLUMBING



FAUCET
Delta Nicoli
Widespread Stainless



SINK
Kohler K-20000-0
Caxton Rectangular
20.25" Undermount



Kohler K-26077-0
Kingston Comfort Height
2 Piece Elongated White

GROVE AT HARVEST DISTRICT LOT 6 • MASTER BEDROOM CEILING CONCEPT

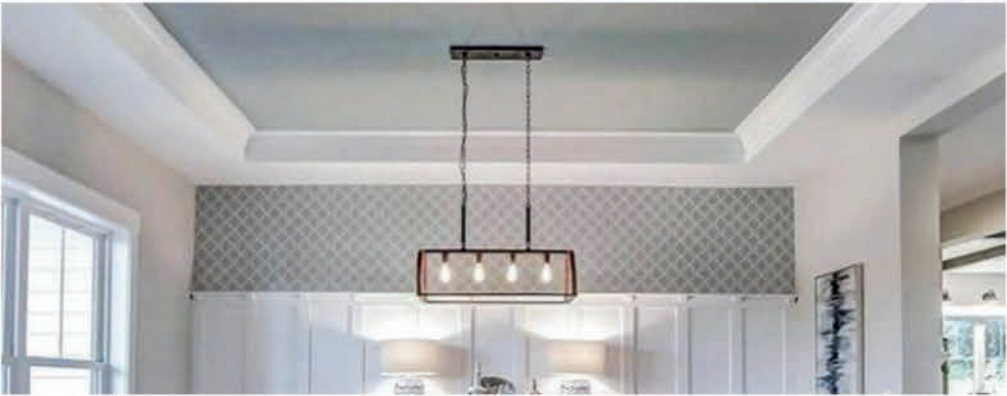

Perimeter Soffit w/ Crown & Accent Paint



18" wide, 12" Deep Perimeter Soffit W/ Crown Accent paint

GROVE AT HARVEST DISTRICT LOT 6 • MASTER BATH

Mirror: Framed to Match Cabinets
Bath Accessories: Brushed Nickel

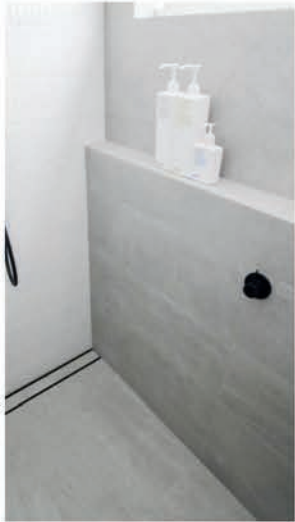

FRAMELESS SHOWER DOOR
Brushed Nickel Hardware

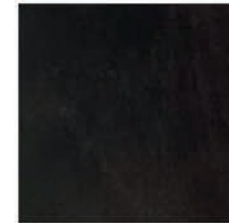

CABINET FINISH
Nightfall



COUNTERTOP
Quartz: Pompeii Valley Frost
Edge: Eased w/ 4" backsplash



CABINET HARDWARE
Emtek Alexander Pull
Brushed Nickel 6"

SHOWER LEDGE
Same Shower Wall Material
*Run Length of Back Wall Approx 48" H

SHOWER FLOOR
Tesoro Sliced Basketweave
Bianco Carrara/Thassos Dot
Grout: Mapei White

CABINET DOOR
Wellborn Florence

FLOORING
Emser Serendra Mila 31x31 Matte
Grout: Mapei White



SHOWER WALLS
Tesoro Vetri Bianco 4x12
Vertically Stacked Run Below
48" Ledge Around Perimeter
Grout: Mapei Warm Gray



SHOWER WALLS
Emser Serendra Mila 12x24
Polished Vertically Stacked,
Run Above 48" Ledge Around
Perimeter, Use Nickel Schluter
Where Needed
Grout: Mapei White



GROVE AT HARVEST DISTRICT LOT 6 • MASTER BATH

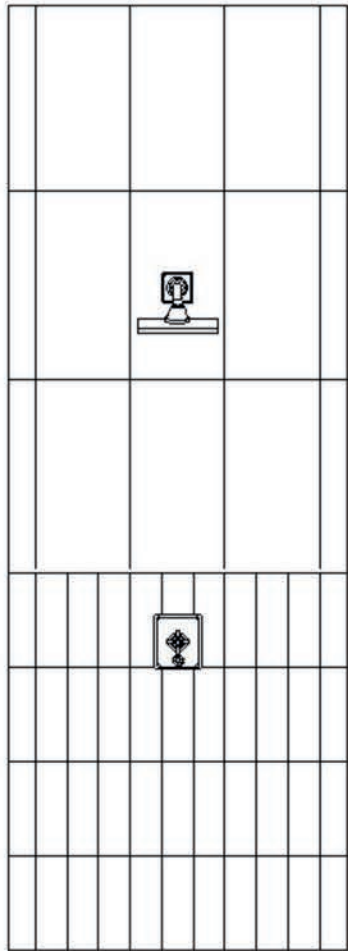

LEFT SIDE FACING

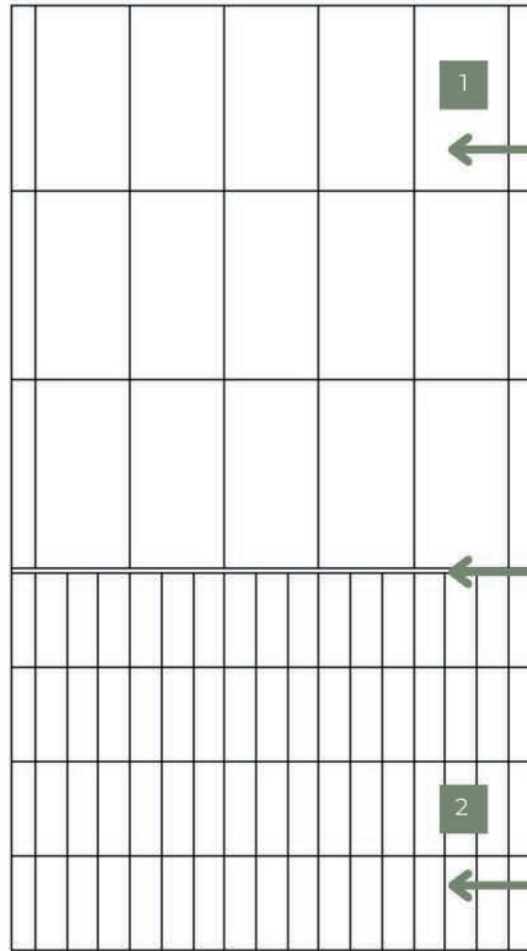

BACK WALL



SHOWER WALLS
Emser Serendra Mila 12x24
Polished Vertically Stacked,
Run Above 48" Ledge Around
Perimeter

SHAMPOO LEDGE APPROX. 48"H

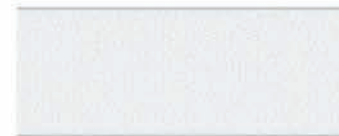

SHOWER WALLS
Tesoro Vetri Bianco 4x12
Brick Joint

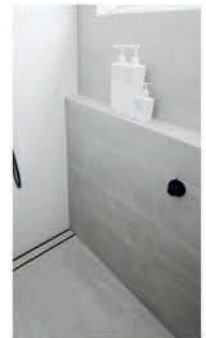

SHOWER LEDGE
Same Shower Wall
Material
*Run Length of Back
Wall Approx 48" H

GROVE AT HARVEST DISTRICT LOT 6 • MASTER BATH PLUMBING

Brushed Nickel Bath Accessories and Shower Door Hardware



TUB FAUCET
Kohler KT27025 Occasion
Tub Filler Brushed Nickel



SHOWER
Rainhead Kohler K13689 10"
Brushed Nickel



SHOWER
Kohler Occasion Cross Handles
Brushed Nickel



FAUCET
Kohler Occasion Widespread
w/ Cross Handles
Brushed Nickel



Wyndham Collection
WCOBT101267SWTRIM
Carissa 67" Free Standing
Acrylic Soaking Tub



SINK
Kohler K-20000-0 Caxton
Rectangular 20.25" Undermount



Kohler K-26077-0 Kingston
Comfort Height 2 Piece
Elongated Toilet

GROVE AT HARVEST DISTRICT LOT 6 • MASTER CLOSET



FINISH
White

CLOSET ROD BEDROOM #4
Brushed Nickel

GROVE AT HARVEST DISTRICT LOT 35 • BATH #2

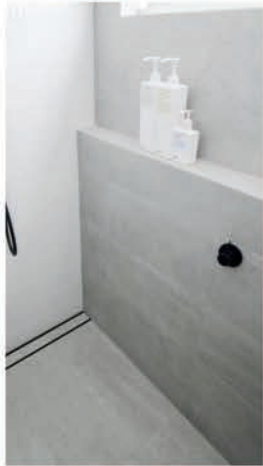

SHOWER LEDGE
Same Shower Wall Material
*Run Length of Right Side Facing Wall Approx 48" H



CABINET DOOR STYLE & FINISH
1951 Denver
Maple Almond



CABINET HARDWARE
Richleau BP79538195
Brushed Nickel

*Mirror: Framed to Match Cabinets
Bath Accessories: Brushed Nickel*



FLOORING
Emser Porto II White Matte 12x24
Grout: Mapei Warm Gray



SHOWER WALLS
Emser Porto II White Matte & Porto White Polished Alternating Rows of Polished & Matte For "Cabana Stripe" 12x24, Use Nickel Schluter Where Needed
Grout: Mapei Warm Gray



SHOWER FLOOR
Elysium Aether Loft
Grout: Mapei White



COUNTERTOP
Quartz: Sonno C-Supreme
Edge: Eased w/ 4" backsplash

FRAMELESS SHOWER DOOR
Brushed Nickel Hardware

GROVE AT HARVEST DISTRICT LOT 6 • BATH #2

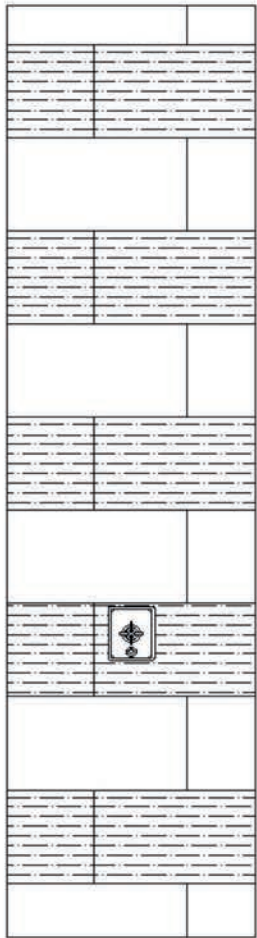

LEFT SIDE FACING

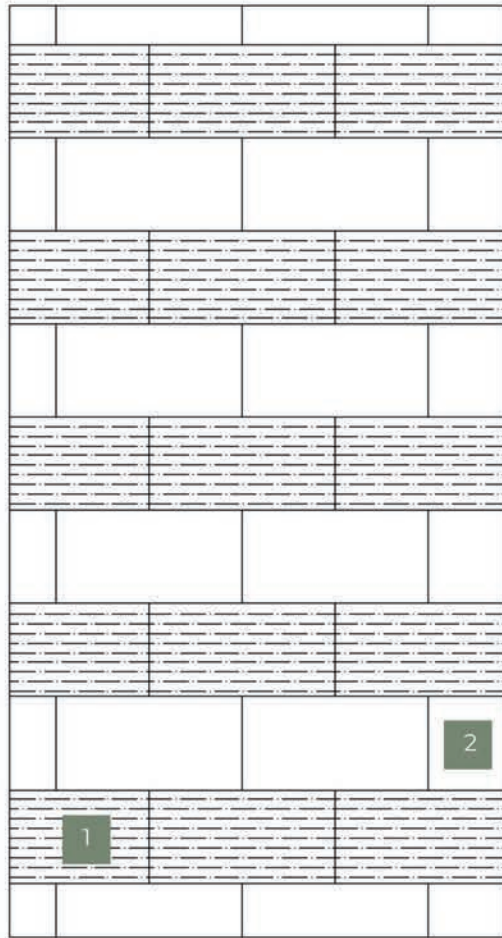

BACK WALL

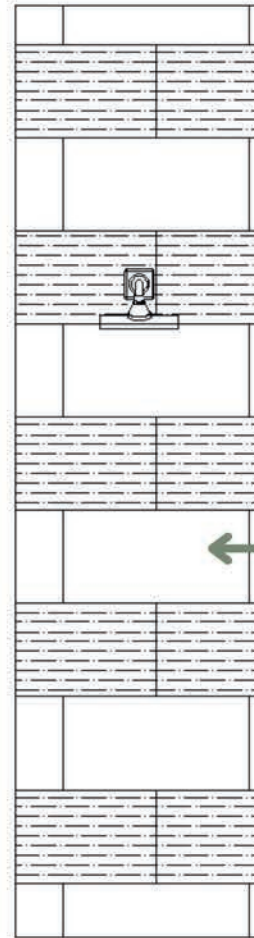

RIGHT SIDE FACING

1



SHOWER WALLS
Emser Porto II White Matte-
Alternating Rows of Matte For
"Cabana Stripe"



SHOWER LEDGE
Same Shower Wall
Material
*Run Length of Back
Wall Approx 48" H

2



SHOWER WALLS
Emser Porto II White Polished -
Alternating Rows of Polished for
"Cabana Stripe"

GROVE AT HARVEST DISTRICT LOT 6 • BATH #2 PLUMBING



SHOWER FAUCET
Moen Belfield
Brushed Nickel



FAUCET
Moen Belfield Widespread Faucet
Brushed Nickel



SINK
Kohler K-20000-0
Caxton Rectangular
20.25" Undermount



Kohler K-26077-0 Kingston
Comfort Height 2 Piece
Elongated Toilet

GROVE AT HARVEST DISTRICT LOT 6 • BATH #3 UP

FRAMELESS SHOWER DOOR
Brushed Nickel Hardware



CABINET DOOR STYLE & FINISH
1951 Denver
Maple Black



COUNTERTOP
Quartz: Pompeii White
Lightning Edge: Eased

*Mirror: Framed to Match Cabinets
Bath Accessories: Brushed Nickel*



SHOWER FLOOR & NICHE
Tarmak Eclipse Bianco Dolomite, Iceberg, & White
12x12 Mosaic Polished
*Run Vertically in Niche & Back to Front on Shower Floor
Grout: Mapei Frost



CABINET HARDWARE
Richleau: 7853
Brushed Nickel



FLOORING
Happy Floors Waves Foam
Natural 12x24, Install Offset, Grout:
Mapei Alabaster



SHOWER WALLS
Happy Floors Waves Foam
Natural 12x24, Install Offset, Use
Nickel Schluter Where Needed
Grout: Mapei Alabaster

GROVE AT HARVEST DISTRICT LOT 6 • BATH #3 UP

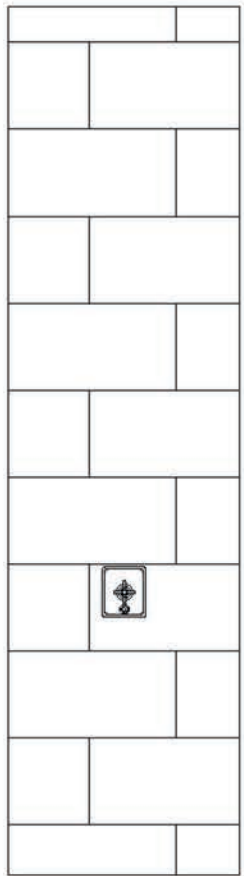

LEFT SIDE FACING

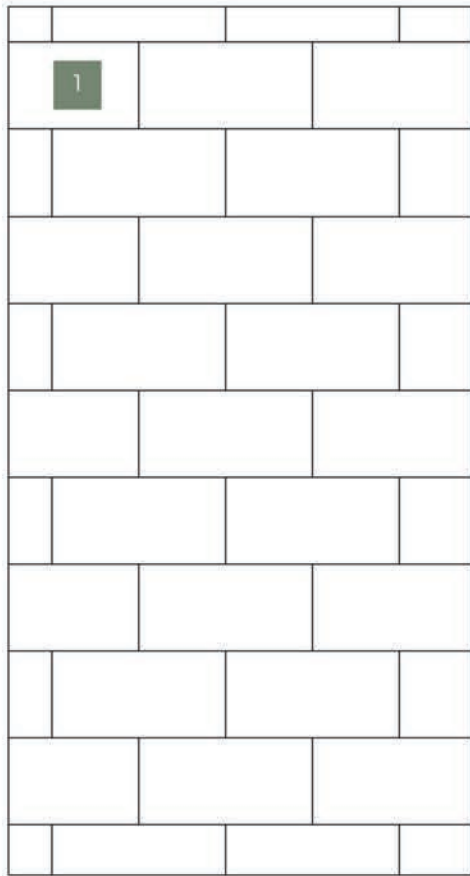

BACK WALL

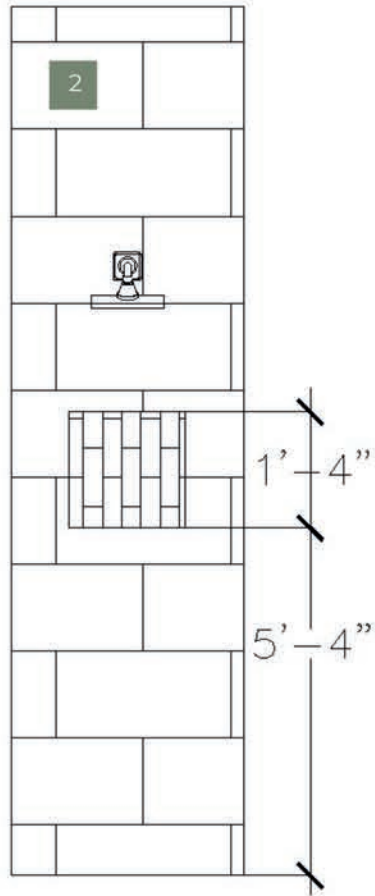

RIGHT SIDE FACING

1



SHOWER WALLS
Happy Floors Waves Foam
Natural 12x24, Install Offset, Use
Nickel Schluter Where Needed

2



NICHE
Tarmak Eclipse Bianco Dolomite,
Iceberg, & White 12x12 Mosaic
Polished *Run Vertically in Niche

GROVE AT HARVEST DISTRICT LOT 6 • BATH #3 UP PLUMBING



FAUCET
Kohler K27399 Riff Widespread
Brushed Nickel



SHOWER FAUCET
Kohler TS27404 Riff
Brushed Nickel



SINK
Kohler K-20000-0
Caxton Rectangular
20.25" Undermount



Kohler K-26077-0 Kingston
Comfort Height 2 Piece
Elongated Toilet

GROVE AT HARVEST DISTRICT LOT 6 • BATH #4 UP & PLUMBING

Mirror: Framed to Match Cabinets
Bath Accessories: Brushed Nickel



CABINET DOOR STYLE & FINISH
1951 Denver
Painted Boulder



CABINET HARDWARE
Richleau BP905160900



COUNTERTOP
Pompeii White
Lightening
Edge: Eased w/ 4" backsplash



FLOORING
Happy Floors Fibra Silver Matte
12x24 Brick Joint, Bullnose Trim
Grout: Mapei Silver



SHOWER WALLS & NICHE:
Emser Sterlinall Silver Polished
12x24 Brick Joint, Bullnose Trim
Grout: Mapei Warm Gray



SHOWER ACCENT
Daltile Scriptor Oracle 8x9 Hex
Run Aprox 2 Full Rows Vertically
Grout: Mapei Warm Gray



SHOWER FLOOR
Tarmak Bianco Venato
Dolomite 1 1/4" Honeycomb
Grout: Mapei White



SHOWER FAUCET
Signature Hardware Berwyn
Matte Black



FAUCET
Signature Hardware
Berwyn Widespread
SHWSCBW807ZBN
Matte Black



SINK
Kohler K-20000-0
Caxton Rectangular
20.25" Undermount



Kohler K-26077-0 Kingston
Comfort Height 2 Piece
Elongated Toilet

FRAMELESS SHOWER DOOR
Brushed Nickel Hardware

GROVE AT HARVEST DISTRICT LOT 6 • BATH #4 UP

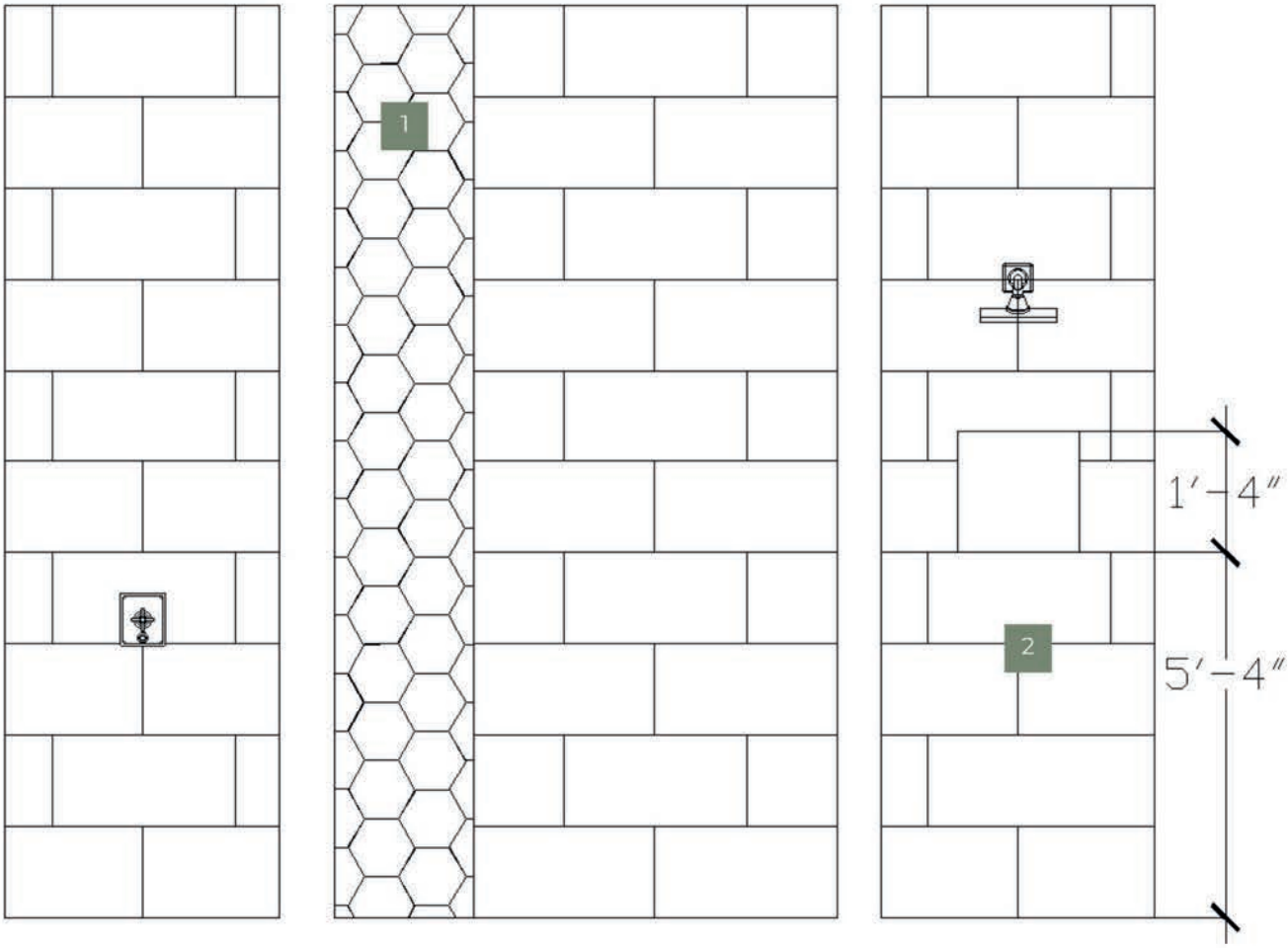

SHOWER ACCENT
 Daltile Scripser Oracle 8x9 Hex
 Run Aprox 2 Full Rows Vertically
 Grout: Mapei Warm Gray



SHOWER WALLS & NICHE:
 Emser Sterlinall Silver Polished
 12x24 Brick Joint
 Grout: Mapei Warm Gray

GROVE AT HARVEST DISTRICT LOT 6 • BATH #5 UP & PLUMBING

Mirror: Framed to Match Cabinets
Bath Accessories: Brushed Nickel



CABINET DOOR STYLE & FINISH
1951 Denver
Maple Harbor



SHOWER FAUCET
Delta Nicoli Shower Faucet
Matte Black

FRAMELESS SHOWER DOOR
Brushed Nickel Hardware



CABINET HARDWARE
Richleau
Matte Black 8726



COUNTERTOP
Quartz: Pompeii Pure
Wood Ash Polished
Edge: Eased



FAUCET
Delta Nicoli Widespread
Matte Black



FLOORING
Emser Sterlina II Silver
Matte 12x24 Install Offset
Grout: Mapei Alabaster



SHOWER FLOOR & BACK OF NICHE
Tarmac - Bardiglio
Offset Polish
Grout: Mapei White



SINK
Kohler K-20000-0
Caxton Rectangular
20.25" Undermount



SHOWER SIDE WALLS
Emser Sterlina II Silver 12x24
Polished Run Horizontally
Stacked Use Matte Black
Schluter Where Needed
Grout: Mapei Alabaster



SHOWER WALLS
Tesoro Earth Snow Glass
4x12 Install as
Herringbone Pattern
Grout: Mapei White



Kohler K-26077-0 Kingston
Comfort Height 2 Piece
Elongated Toilet

GROVE AT HARVEST DISTRICT LOT 6 • BATH #5 UP



1
LEFT SIDE FACING



2
BACK WALL

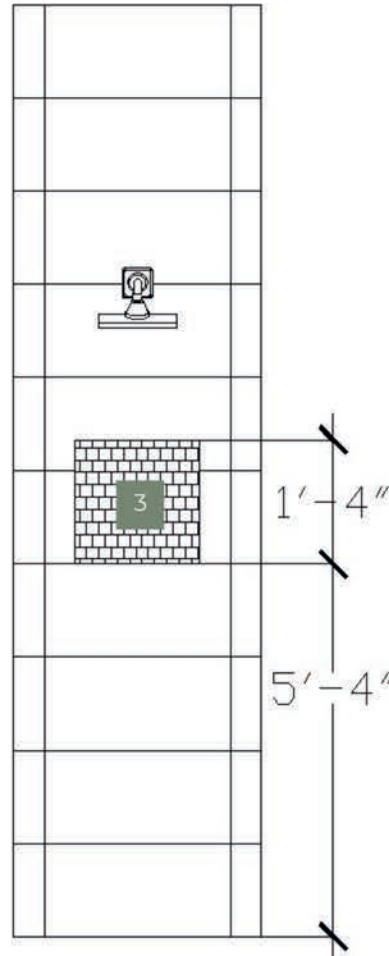

3
RIGHT SIDE FACING



1
SHOWER SIDE WALLS
Sterlina II Silver 12x24 Polished Run
Horizontally Stacked



2
SHOWER WALLS
Tesoro Earth Snow Glass
4x12 Install as Herringbone Pattern



3
BACK OF NICHE
Tarmac - Bardiglio Offset Polish

GROVE AT HARVEST DISTRICT LOT 6 • SECONDARY CLOSETS

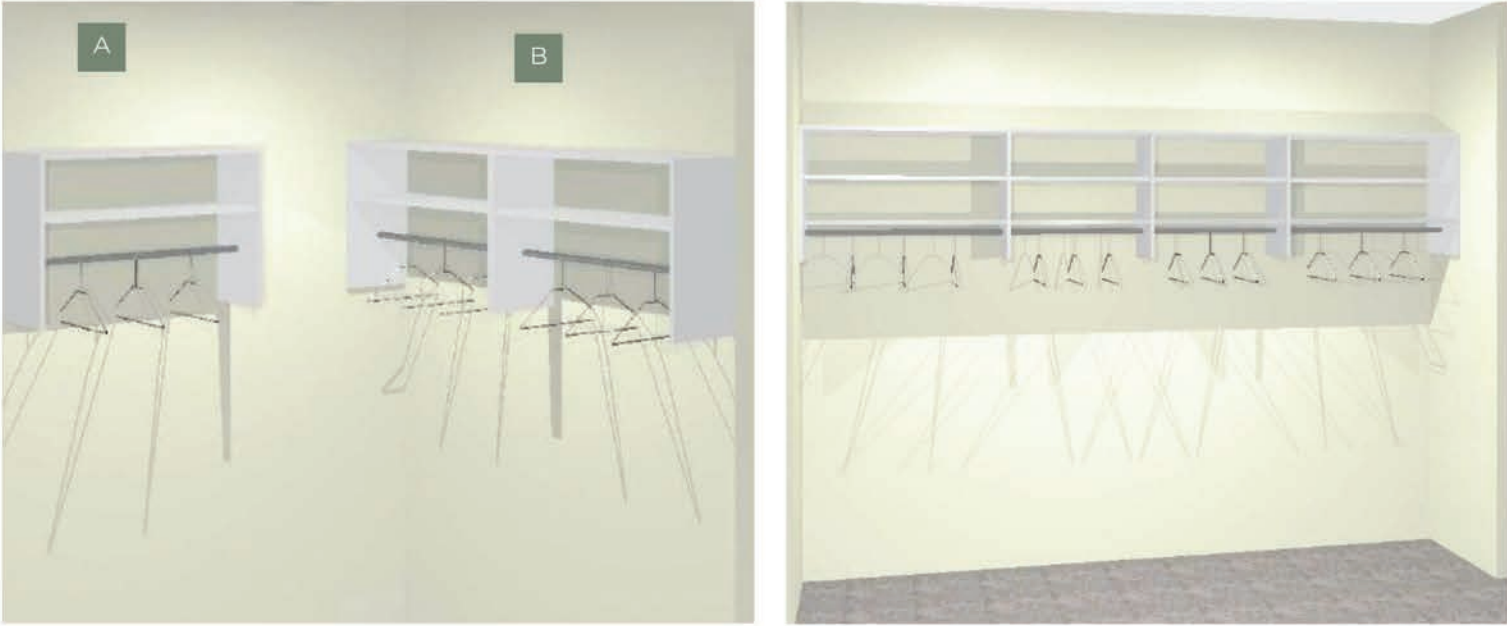

CLOSET FINISH
White Melamine



**BED #3 & #4
CLOSET ROD**
Black



**GUEST DEN & BED #2 UP
CLOSET ROD**
Brushed Nickel

GROVE AT HARVEST DISTRICT LOT 6 • FIRST FLOOR FLOORING SCHEDULE

A Wood: Anderson Tuftex - 15027 Pembridge



B Tile: Mohawk Sinova Cement Gray 12x24



C Tile: Tarmac - Sanibel Carrara/Dolomite



D Tile: Emser Serendra Mila 31x31



E Tile: Emser Porto II White Matte 12x24

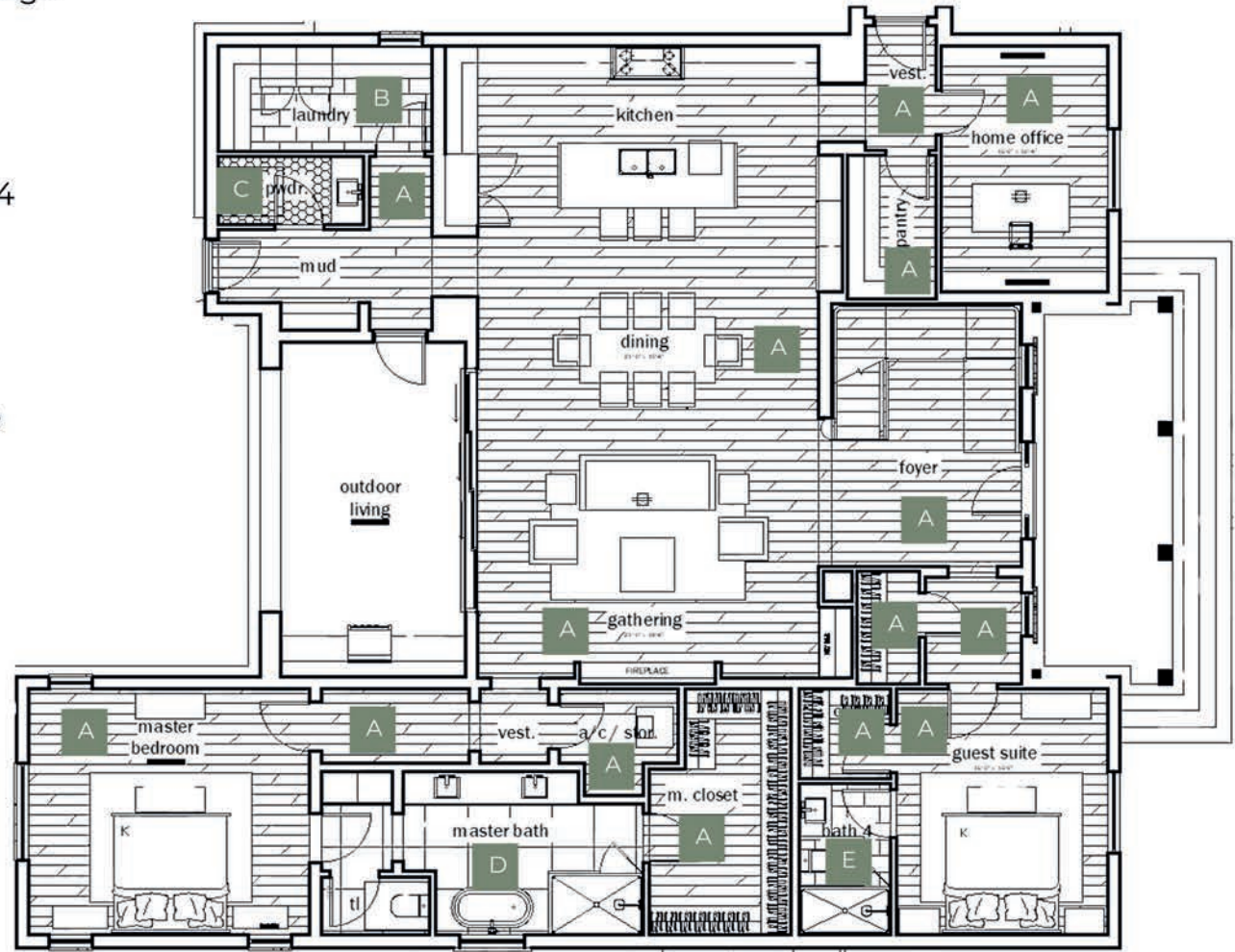

GROVE AT HARVEST DISTRICT LOT 6 • SECOND FLOOR FLOORING SCHEDULE

A Wood: Anderson Tuftex - 15027 Pembridge



F Tile: Emser Porto II White Matte



G Tile: Happy Floors Waves Foam Natural 12x24



H Tile: Happy Floors Fibra Silver Matte 12x24

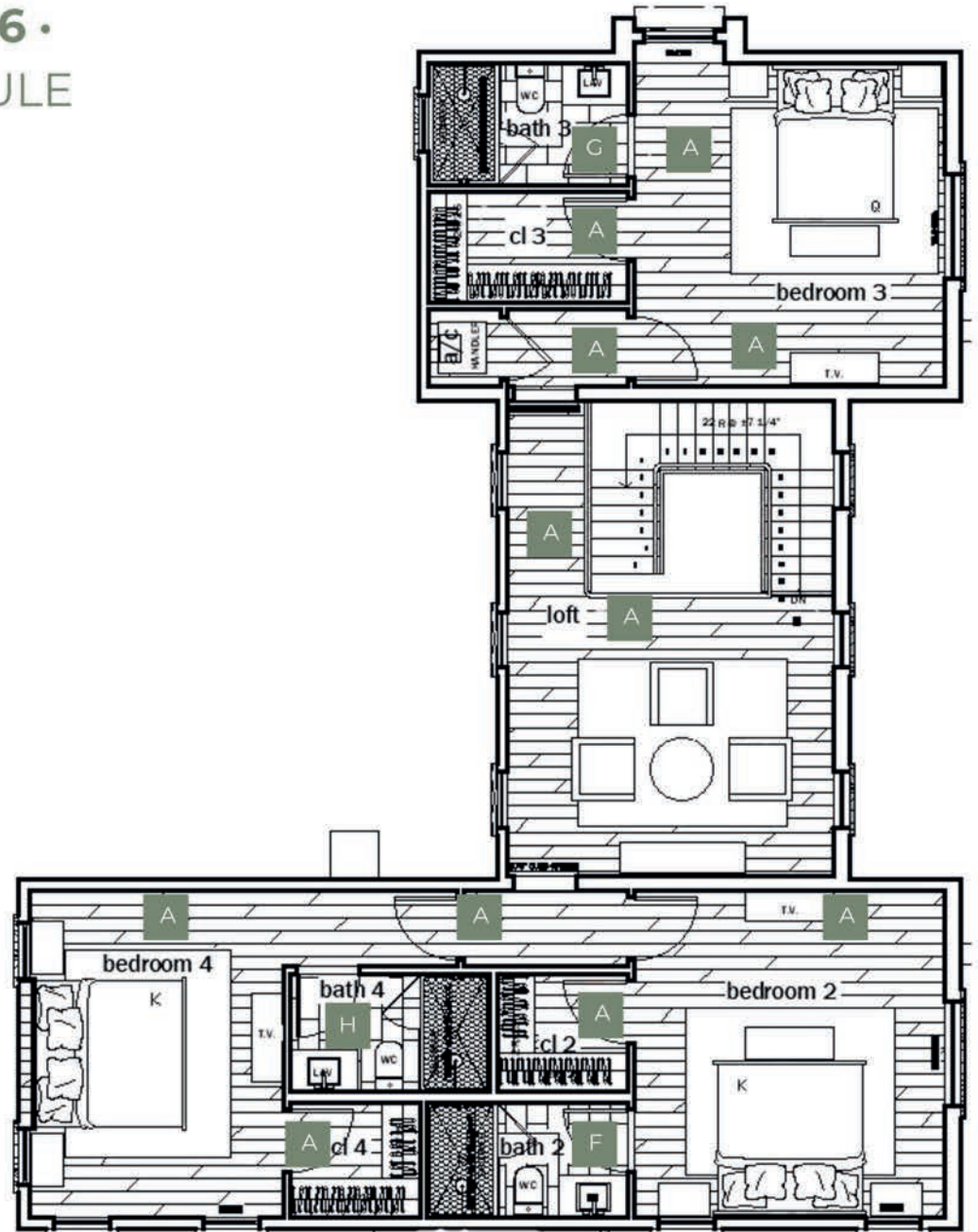

LOT 6

LIGHTING SELECTIONS

GROVE AT HARVEST DISTRICT LOT 6 • EXTERIOR LIGHTING



EXTERIOR LIGHTING
Capital Ellsworth Collection 29" H
Black Size & Qty Per Take Off



EXTERIOR FANS
Minka F787-CL Coal 52"
Qty 2



FLOOD LIGHTS
Maxim 92008WT
White

GROVE AT HARVEST DISTRICT LOT 6 • GARAGE INTERIOR



AFX LWL07485000LAJD1 LED
Wrap 48" Lang
Integrated LED
Commercial Stripe Light 120Volts
- 5000 Lumens QTY: 3

GROVE AT HARVEST DISTRICT LOT 6 • MAIN AREAS



DINING ROOM
Golden Lighting Ciara 42" Wide
Linear Pendant Matte Black 1768-
LP-BLK-HWG



KITCHEN ISLAND
Quorum 6802-6965
Black & Satin Nickel
19" Dia x 19.5" H
Qty 3



STAIRWELL
Hunter Sunjai
40" Dia x 32.25" H
Black 45232

GROVE AT HARVEST DISTRICT LOT 6 • GATHERING ROOM



CEILING FAN
QFanimation Spitfire
Black 60"

GROVE AT HARVEST DISTRICT LOT 6 • POWDER BATH



Progress Atwell 8" Dia Brushed
Nickel P500309-009

GROVE AT HARVEST DISTRICT LOT 6 • PRIMARY BED & BATH



Fanimation Levon 64" Matte
White FPD7912BMW-64MW



BATH VANITIES
Parsons 24"W
Brushed Nickel 6103-84

GROVE AT HARVEST DISTRICT LOT 6 • SECONDARY BATHROOMS



BATH #2
Designers Fountain 93303-BN
Brushed Nickel



BATH #3
Kichler
45497BK Black



BATH #4
Savoy Genry 25"W
Matte Black 8-8204-3-BK



BATH #5
Hinkley Ryden 23"W Black
58063BK

GROVE AT HARVEST DISTRICT LOT 6 • SECONDARY FANS THROUGHOUT



HOME OFFICE, BED #2, BED #3, BED #4, BED #5, & LOFT
Generation Lighting
Jovie 52" Fan
3JVR52MBK
Midnight Black



ELEMENT

HOME BUILDERS

SALES EXECUTIVE · CAROLINA DUMIT · 407.325.8963 · ELEMENTATGROVE.COM